

## PS-12180 12 Volt 18.0 AH Rechargeable Sealed Lead Acid Battery

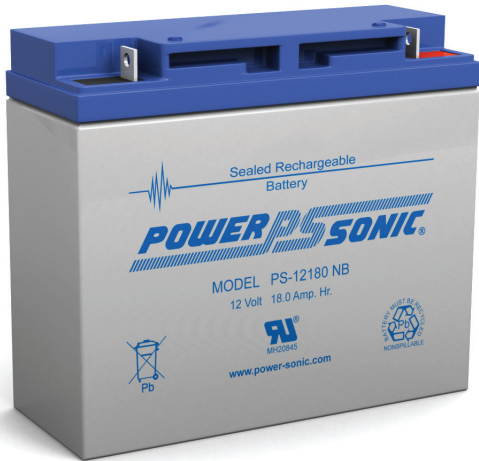

We've Got The Power.™



### Features

- Absorbent Glass Mat (AGM) technology for superior performance
- Valve regulated, spill proof construction allows safe operation in any position
- Power/volume ratio yielding unrivaled energy density
- Rugged impact resistant ABS case and cover (UL94-HB)
- Approved for transport by air. D.O.T., I.A.T.A., F.A.A. and C.A.B. certified
- U.L. recognized under file number MH 20845

### Terminals

(mm)

- PS-12180 F2: Quick disconnect AMP, INC. Faston tabs, 0.250" x 0.032"
- PS-12180 NB2: Tin plated brass post with 5mm nut & bolt connectors

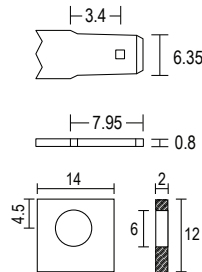

### Physical Dimensions: in (mm)

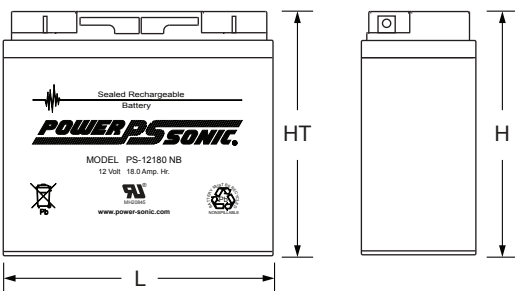
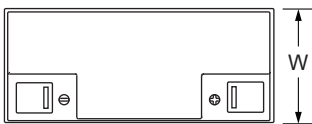

L: 7.13 (181) W: 3.00 (76) H: 6.59 (167) HT: 6.59 (167)

Tolerances are +/- 0.04 in. (+/- 1mm) and +/- 0.08 in. (+/- 2mm) for height dimensions. All data subject to change without notice.

### Performance Specifications

**Nominal Voltage** ..... 12 volts (6 cells)

#### Nominal Capacity

|                                     |         |
|-------------------------------------|---------|
| 20-hr. (900mA to 10.50 volts) ..... | 18.0 AH |
| 10-hr. (1.7A to 10.50 volts) .....  | 17.0 AH |
| 5-hr. (3.2A to 10.20 volts) .....   | 16.0 AH |
| 1-hr. (11.1A to 9.00 volts) .....   | 11.1 AH |
| 15-min. (34.3A to 9.00 volts).....  | 8.58 AH |

**Approximate Weight** ..... 12.60 lbs. (5.72 kg)

**Energy Density** (20-hr. rate) ..... 1.53 W-h/in<sup>3</sup> (93.51 W-h/l)

**Specific Energy** (20-hr. rate) ..... 17.14 W-h/lb (37.79 W-h/kg)

**Internal Resistance** (approx.) ..... 14 milliohms

**Max Discharge Current** (7 Min.) ..... 54.0 amperes

**Max Short-Duration Discharge Current** (10 Sec.)..... 180.0 amperes

#### Shelf Life (% of nominal capacity at 68°F (20°C))

|                |     |
|----------------|-----|
| 1 Month .....  | 97% |
| 3 Months.....  | 91% |
| 6 Months ..... | 83% |

#### Operating Temperature Range

|                |                               |
|----------------|-------------------------------|
| Charge.. ..    | -4°F (-20°C) to 122°F (50°C)  |
| Discharge..... | -40°F (-40°C) to 140°F (60°C) |

**Case** ..... ABS Plastic

**Power-Sonic Chargers** .... PSC-122000A, 124000A, 122000A-C, 124000A-C

### Shelf Life & Storage



### Discharge Characteristics

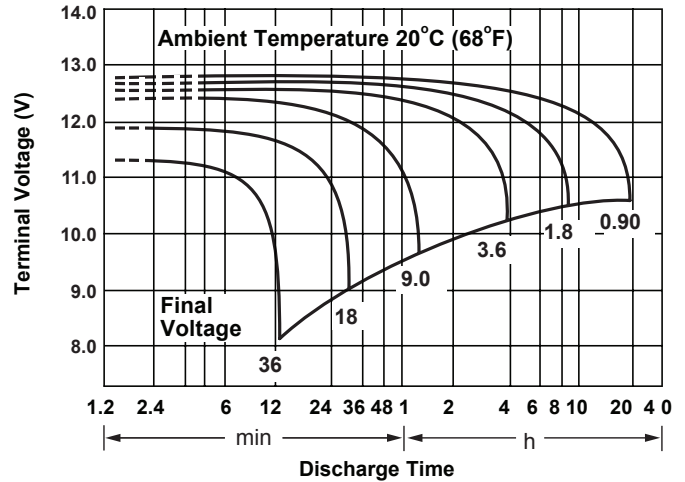

### Discharge Time vs. Discharge Current

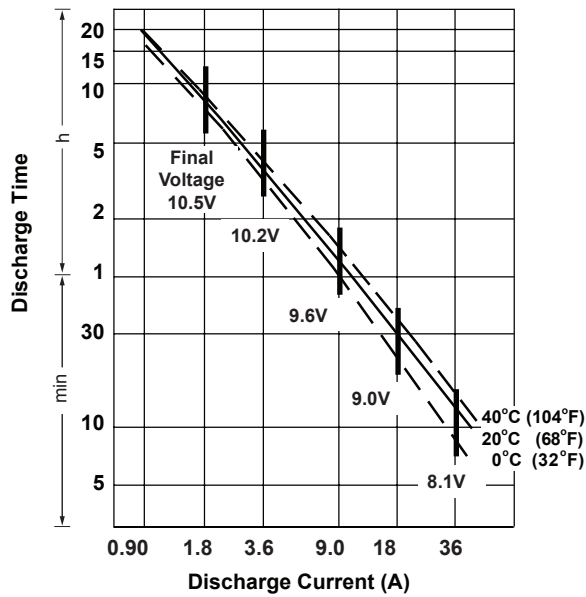

### Life Characteristics in Stand-By Use

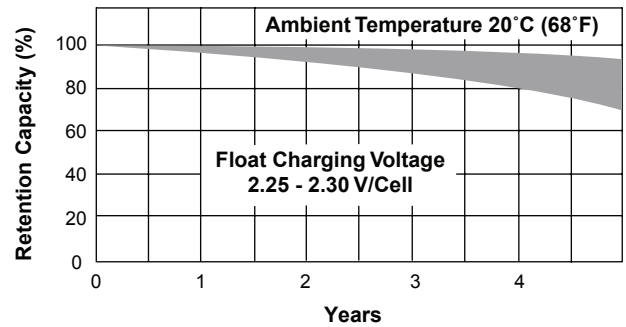

### Charging

**Cycle Applications:** Limit initial current to 5.4A. Charge until battery voltage (under charge) reaches 14.4 to 14.7 volts at 68°F (20°C). Hold at 14.4 to 14.7 volts until current drops to under 180mA. Battery is fully charged under these conditions, and charger should be disconnected or switched to “float” voltage.

**“Float” or “Stand-By” Service:** Hold battery across constant voltage source of 13.5 to 13.8 volts continuously. When held at this voltage, the battery will seek its own current level and maintain itself in a fully charged condition.

**Note:** Due to the self-discharge characteristics of this type of battery, it is imperative that they be charged within 6 months of storage, otherwise permanent loss of capacity might occur as a result of sulfation.

### Life Characteristics in Cyclic Use

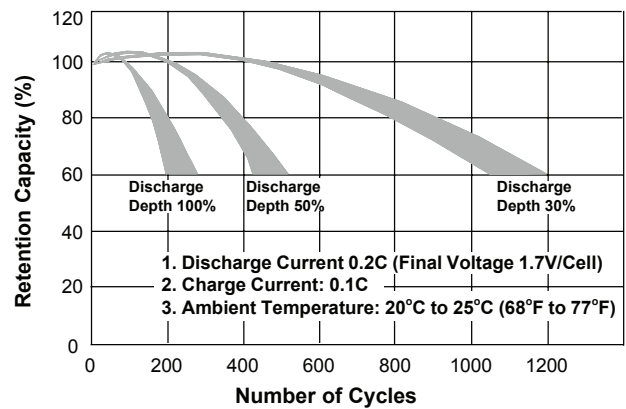

### Chargers

Power-Sonic offers a wide range of chargers suitable for batteries up to 100AH. Please refer to the Charger Selection Guide in our specification sheets for “C-Series Switch Mode Chargers” and “Transformer Type A and F Series”. Please contact our Technical department for advice if you have difficulty in locating suitable models.

### Further Information

Please refer to our website [www.power-sonic.com](http://www.power-sonic.com) for a complete range of useful downloads, such as product catalogs, material safety data sheets (MSDS), ISO certification, etc..

### Contact Information

[www.power-sonic.com](http://www.power-sonic.com)

#### DOMESTIC SALES

Tel: +1-619-661-2020  
 Fax: +1-619-661-3650  
 national-sales@power-sonic.com

#### CUSTOMER SERVICE

Tel: +1-619-661-2030  
 Fax: +1-619-661-3648  
 customer-service@power-sonic.com

#### TECHNICAL SUPPORT

Tel: +1-619-661-2020  
 Fax: +1-619-661-3648  
 support@power-sonic.com

#### INTERNATIONAL SALES

Tel: +1-650-364-5001  
 Fax: +1-650-366-3662  
 battery@power-sonic.com